

Black aircraft cable

Manufactured in Korea and or China this cable is made by Powder coating aircraft cable.

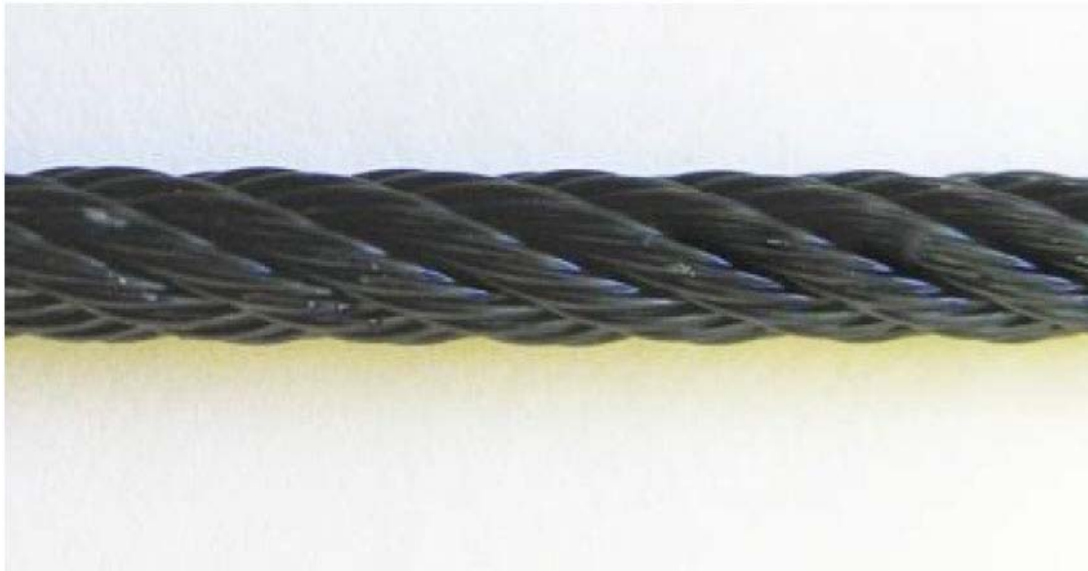

Dimension	Type	Spool Size	Nominal Breaking Strength	
			lbs	kg
1/16"	7 X 7	500 & 1000 ft	480	218
1/8"	7 X 19	500 & 1000 ft	2000	907
3/16"	7 X 19	500 ft	4200	1900
1/4"	7 X 19	250 & 500 ft	7000	3175

Black Coated Cable

Manufactured in Calgary this cable is made by coating offshore aircraft cable with a tough and durable PVC coating. The colour is flat black to best fade into the background.

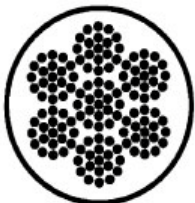

Dimension	Type	Coated Dimension(approximate)	Nominal Breaking Strength	
			lbs	kg
1/16"	7 X 7	3/32"	480	218
3/32"	7 X 7	1/8"	920	417
1/8"	7 X 19	3/16"	2000	907
3/16"	7 X 19	1/4"	4200	1900
1/4"	7 X 19	5/16"	7000	3175

***IMPORTANT:** *Coating must be stripped before terminations are applied.*

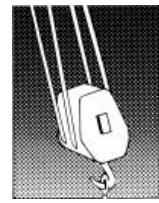

Galvanized Aircraft Cable

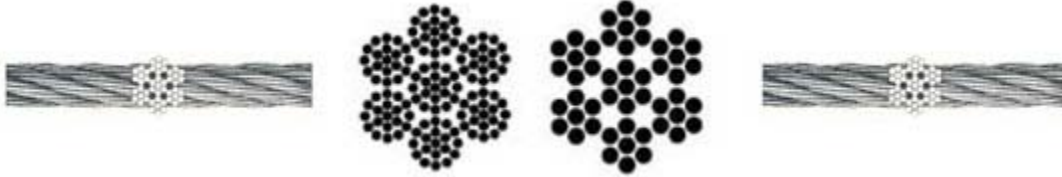

Manufactured offshore from a high strength specially processed wire it used where high strength in small size is required.

Dimension	Type	Nominal Breaking Strength	
		lbs	kg
1/32"	3 X 7	110	49
1/16"	7 X 7	480	217
3/32"	7 X 7	920	414
3/32"	7 X 19	1000	453
1/8"	7 X 19	2000	907
3/16"	7 X 19	4200	1905
1/4"	7 X 19	7000	3176
5/16"	7 X 19	9800	4446
3/8"	7 X 19	14400	6533
1/2"	7 X 19	22800	10344

Rotation Resistant Ropes

The ability to fly in a chandelier or similar object on a single line with no bridles is possible with rotation resistant ropes. Special handling considerations are required when using rotation resistant rope. Rotation resistant cable is more temperamental than ordinary cable types. Do NOT use aluminum compression sleeves on stainless cable, copper only. Ends must be seized before cutting. A minimum design factor of 5:1 is recommended 10:1 is preferred where possible.

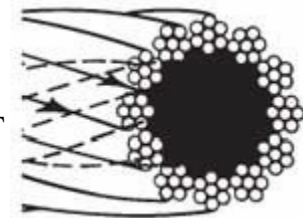

Dimension	Construction	Nominal Breaking Strength	
		lbs	kg
3/16"	Improved Plow 19 X 7	2840	1288
1/4"	Improved Plow 19 X 7	5020	2277



Fittings

Swage Sleeves

All of the oval sleeves that we supply (copper or aluminum) are capable of supporting a greater load than the rated breaking strength of the cable to which they are attached when properly applied. Only one sleeve is needed to achieve this rating when making an eye though sometimes a second sleeve is applied to hide the



“bitter ends “of the wire sticking out. Two sleeves are required to make a lap splice. Stop sleeves are only capable of holding 1/3 to 1/2 of the rated breaking strength of the cable to which they are attached. Regular checks of your tool with a "go-no-go" gauge are imperative to ensure proper compression. On stainless steel cables copper or stainless sleeves are required.

AVAILABLE FOR CABLE FROM 1/32" - 5/16"

USITT guidelines and Draft ESTA standards recommend Only copper for overhead lifting and permanent rigging.



Thimbles

Thimbles should be used whenever a rope or wire rope is formed into a tight eye. We offer three styles, AN cold rolled zinc plated steel, Standard thimbles and Heavy duty. Stainless steel and rope thimbles are also available. On smaller sized cables, we find using an oversized thimble often makes the attachment of fittings easier. Below is a 1/8” standard, a 3/16 AN Zn, and a 1/8” AN Zn Thimble.

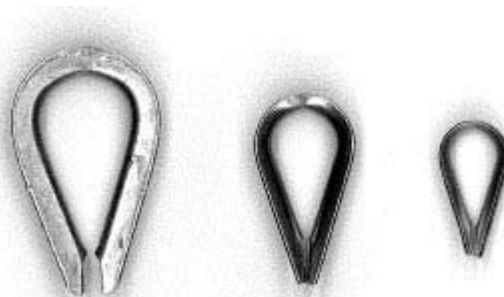



AN Zinc Thimbles

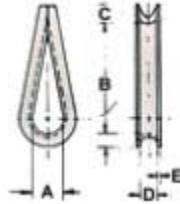

To Fit Cable Dia. In Inches	Cold Rolled Steel Zinc Plated Part No.	A	B	C	D	E	F
3/64 , 1/16 , 5/64 , 3/32	AN 100-3*	.350	43/64	3/16	3/32	.032	5/64
3/32 , 7/64 , 1/8	AN 100-4*	.350	45/64	7/32	9/64	.032	5/64
5/32	AN 100-5*	.400	51/64	7/32	11/64	.032	7/64
3/16	AN 100-6*	.500	1	5/16	13/64	.032	11/64
7/32 , 1/4	AN 100-8*	.700	1-13/32	13/32	17/64	.032	11/64
9/32 , 5/16	AN 100-10*	.900	1-51/64	7/16	21/64	.040	7/32
3/8	AN 100-12*	1.00	2	5/8	25/64	.060	17/64

AN thimbles come in either cold-rolled steel (zinc plated) or stainless steel (natural finish). Fit cable diameters from 1/16” to 3/8” to meet the most demanding marine, aircraft or industrial requirements. AN Thimbles meet all Military Specifications.

Standard Thimbles

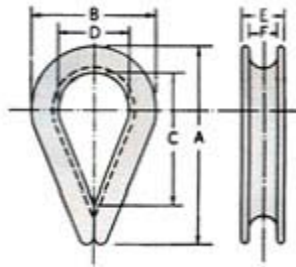

Part No	Cable Dia	A	B	C	D	E	F
EY411-4*	1/8	2	1-1/8	1-3/8	5/8	9/32	5/32
EY411-6*	3/16	2	1-1/8	1-3/8	5/8	11/32	1/4
EY411-8*	1/4	2	1-1/8	1-7/16	11/16	3/8	5/16
EY411-10*	5/16	2-1/8	1-1/4	1-1/2	13/16	15/32	3/8
EY411-12*	3/8	2-3/8	1-1/2	1-11/16	1	17/32	7/16

Down Stage Right -Theatrical and Entertainment Rigging Supplies

Office 403.229.0720 Toll Free 1.888.929.0720 Fax 1.866.858.6421

1914 – 5A St SW Calgary, Alberta, Canada T2S 2G1



EY411-14*	7/16	2-11/16	1-3/4	1-15/16	1-1/8	11/16	9/16
EY411-16*	1/2						
EY411-18*	9/16	3-1/2	2-3/8	2-1/4	1-7/16	15/16	11/16
EY411-20*	5/8						
EY411-24*	3/4	3-3/4	2-3/4	2-11/16	1-5/8	1-1/8	13/16
EY411-28*	7/8	5	3-1/8	3-9/16	1-7/8	1-9/32	1

Heavy Duty Thimbles

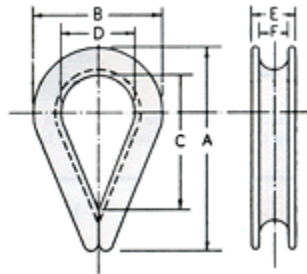

Part No	Cable Dia	A	B	C	D	E	F
EY414-8*	1/4	2-1/4	1-1/2	1-5/8	7/8	15/32	5/16
EY414-10*	5/16	2-5/8	1-13/16	1-7/8	1-1/16	17/32	3/8
EY414-12*	3/8	3	2-1/8	2-1/8	1-1/8	21/32	7/16
EY414-14*	7/16	3-1/2	2-3/8	2-5/16	1-1/4	3/4	1/2
EY414-16*	1/2	3-5/8	2-3/4	2-3/4	1-1/2	15/16	9/16
EY414-18*	9/16	3-5/8	2-11/16	2-3/4	1-1/2	15/16	5/8
EY414-20*	5/8	4-1/4	3-1/8	3-1/4	1-3/4	1-1/32	11/16
EY414-24*	3/4	5	3-13/16	3-3/4	2	1-1/4	13/16
EY414-28*	7/8	5-1/2	4-1/4	4-1/4	2-1/4	1-7/16	1

Wire Rope Clips & Fist Grips



Often generically referred to as Crosby clips and occasionally as bulldogs we offer both forged and malleable wire rope clips. Forged clips are required for use in overhead lifting. The malleable clips are recommended for non critical light duty applications such as guard rails, guy wires etc. The efficiency rating on the proper number of properly applied wire rope clips is 80% of the strength of the wire rope. We offer both offshore and Genuine Crosbie Wire Rope Clips. Fist Grips have a couple of advantages over Wire Rope clips in that they are impossible to apply incorrectly and they damage the rope



less in situations where the clip will be removed.

Down Stage Right -Theatrical and Entertainment Rigging Supplies

Office 403.229.0720 Toll Free 1.888.929.0720 Fax 1.866.858.6421

1914 – 5A St SW Calgary, Alberta, Canada T2S 2G1



Clip size	Number of forged clips	Number of malleable clips	Amount of turn back required	Torque in ft. lbs.
1/8"	2	3	3 1/4"	4.5
3/16"	2	3	3 3/4"	7.5
1/4"	2	3	4 3/4"	15
5/16"	2	3	5 1/4"	30
3/8"	2	3	6 1/2"	45

Wire rope clips must be re tightened after applying load. In accordance with good rigging practice wire rope and its terminations should be regularly inspected.

Slings, Drifts, and Cables

Wire Rope

Whatever the nomenclature we can supply the cables you need. For hanging chain hoists and the like, we have 5's, 10's, 20's in 3/8 or 1/2" steel. These are manufactured with a Flemish eye splice and then secured with a pressed tapered steel sleeve. Each end has a heavy-duty thimble. We can also fabricate the cables you require for the suspension of scenery with cable from 1/32" to 1/4" with the fittings of your choice..

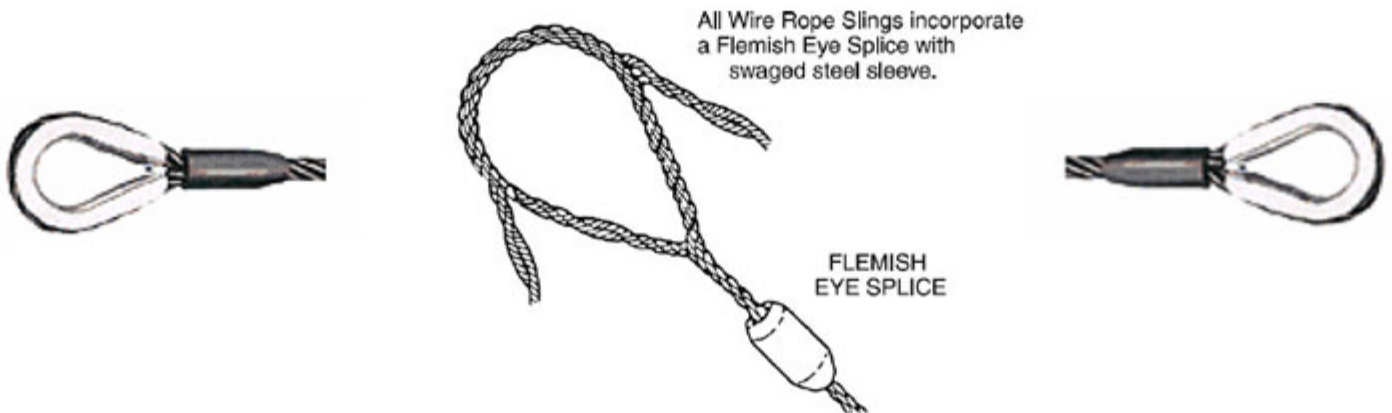

Slings are made with Heavy Duty Thimbles and Flemished Spliced Eyes on each end. 3/8" Thimble Eyes will accept a 5/8" Shackle, 1/2" Thimbles will accept a 3/4" Shackle.

Down Stage Right -Theatrical and Entertainment Rigging Supplies

Office 403.229.0720 Toll Free 1.888.929.0720 Fax 1.866.858.6421

1914 – 5A St SW Calgary, Alberta, Canada T2S 2G1



Rope Diameter (inches)	Vertical Lift	Choker Hitch	Basket Hitch
1/4	1200	900	2400
3/8	2600	1940	5200
1/2	4400	3200	8800

Polyester Tube Slings, Spansets, Round slings, Steel Round slings, Steel Flex sling, Soft Steel



Different Brand or trademark names for similar but very different products. When looking at a lifting sling from an aluminum tube’s point of view, it prefers supple, soft and nonabrasive slings. A round sling is the perfect choice rather than a steel sling. Round slings are made of many strands of polyester covered with a protective polyester sheath.

Down Stage Right -Theatrical and Entertainment Rigging Supplies

Office 403.229.0720 Toll Free 1.888.929.0720 Fax 1.866.858.6421

1914 – 5A St SW Calgary, Alberta, Canada T2S 2G1

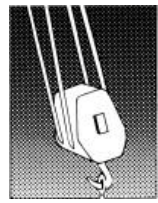

Unfortunately, polyester melts at approx. 250°C (~480°F). Research has shown that a 2k luminair-housing can reach temperatures of about 190°C (~370°F), with the truss-chord straight over it being almost 140°C (~280°F). Accidents have been reported of round slings being melted by spots, pyro or the heat of the rays, and as a result, trusses have fallen. When round slings are used, a safety backup must be applied such as a wire rope or chain sling.

So rather than have a backup steel sling why not make the sling out of steel but softer than a single cable. A steel round sling has a normal outside webbing for soft slings, but instead of the polyamide core, the steel round sling has a core made of many small steel cables, which makes it resistant to high temperatures. The steel wires within the steel round are as flexible as a normal soft sling, but have a much better fire resistance. The steel round can be used in circumstances where the normal soft slings are not allowed.

The outside webbing is black, including an identification label and a hidden inspection window to inspect the steel wires within the sling. The wire-rope core has better heat resistance than the truss itself.

Black Steel Round sling with Galvanized Aircraft Cable on the inside.

- Increased Safety, Higher Heat Resistance
- No Backup rigging required
- Conforms load to grip easily
- unique inspection window allows for easy inspection of steel cable.

Rated Capacity: Vertical :5300 lbs. Choker :4200 lbs. Basket :10200 lbs.

Safety cables

Safety cables for lights are available. 30” Long made with 1/8” black power coated aircraft cables fitted with a 5/16 ferruled steel snap.

ROPES & CORDS

Down Stage Right can supply most of your rope and cordage requirements from twill tape and black cotton tie line to large diameter manila and polyester ropes and braids. To make life very very confusing the synthetic fibre ropes are all available in either a 3 strand, solid braid, double braid or parallel core configuration in nylon, polyester or more exotic materials. Polyester ropes are available in a spun or non spun finish. Due to the huge number of different sizes, colours, materials and braid types combinations (and to simplify things) Down Stage Right Industries stocks several favourites that we have found the theatrical industry usually purchases. If you need a particular rope we are happy to bring in the particular configuration and colour that you want. Please call for details or recommendations for a particular product.

Down Stage Right -Theatrical and Entertainment Rigging Supplies

Office 403.229.0720 Toll Free 1.888.929.0720 Fax 1.866.858.6421

1914 – 5A St SW Calgary, Alberta, Canada T2S 2G1



Twill Tape

Twill tape is a flat twill-woven ribbon of cotton, linen, polyester, or wool. Used in attaching soft goods and electrical cables to pipes we offer both cotton and polyester twill in 100 yard rolls.

Tie Line

Used as a general purpose tie line for drops or cables it is offered in 1000 and 3000' spools. Available in cotton and polyester. Size 4, #4.5 or 1/8" and #5.

Sash Cord

The primary advantage of sash cords are their handling characteristics and their knot holding ability. It does not have the strength or durability of double braids. Available in white as a cotton polyester blend or in black as spun polyester. Sash braid is generally a coarser cousin of solid braid.

Whipping Line

A bees waxed polyester fibre used for whipping the ends of ropes. Available in a 40lb and 100lb test.

Trick line

50 yd spools of 108# test 1/32" line used for effects

Manila

Often mislabeled as hemp, manila is significantly stronger and is used in for hand lines in counterweight rigging and as general purpose spot line rope. We only carry #1 grade sea worthy manila. Manila has generally been replaced by synthetics in our industry

DIAMETER	TENSILE STRENGTH (LBS)	MAX. WORKING LOAD (LBS)
1/2	2380	264
9/16	3100	388
5/8	3960	496
3/4	4860	695
7/8	6950	995

Working loads are guidelines only. Once put into service rope is continually deteriorating. Manila rope will deteriorate in storage even under ideal conditions.

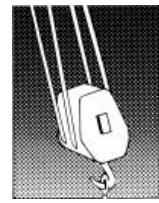

Solid Braids

Solid braid ropes are sometimes referred to as “sash cord” because this pattern was used to raise sash windows. It is formed by braiding 8 to 18 strands in a reasonably complicated pattern with all the strands rotating in the same direction on the braider. The individual stitches are oriented in the same direction as the rope. The center may contain a filler core. These ropes maintain their round shape well and therefore work exceptionally well in pulleys and sheaves. They tend to have high elongation and are generally less strong than other forms of construction, and are difficult to splice.

Size	DIAMETER	TENSILE STRENGTH (LBS)		MAX. WORKING LOAD (LBS)	
	In (mm)	nylon	polyester	nylon	polyester
#2	1/16,(1.5)	270	126	22.5	12.6
#4	1/8 (3.2)	600	450	50	45
#5	5/32 (4.0)				
#6	3/16 (4.8)	1450	1300	120	130
#8	1/4 (6)	1840	1700	153	170
#10	5/16 (8)	2880	2600	240	260
#12	3/8 (10)	4140	3750	414	375

Double Braid

"Double braid" ropes, also referred to as "Marine Ropes" or "Yacht Braid" or “2 in 1” are perhaps the most well known braided rope on the market today. They are constructed of a hollow braided rope, which acts as a core inside another braided rope. The combination of the 2 ropes in 1 results in a rope with higher tensile strength than commonly found in twisted ropes. The inner rope and outer rope are generally designed to share the load fairly evenly. Double braid ropes have a torque free construction, and are easily spliced. However, caution must be exercised where double braid ropes are run over pulleys, through hardware or in any situation where the outer rope may slide along on the inner rope and bunch up. This condition, often called "milking", will cause dramatic loss of strength by causing the entire load to go onto the inner rope, because the sheath is bunched up and therefore not under the same tension as the inner rope. Polyester double braid ropes big advantage is that they do not have the same stretch as nylon. They can also be made with a soft “spun” covering giving a better hand feel. The elasticity of nylon ropes can absorb sudden shock loads that would break other ropes.

Down Stage Right -Theatrical and Entertainment Rigging Supplies

Office 403.229.0720 Toll Free 1.888.929.0720 Fax 1.866.858.6421

1914 – 5A St SW Calgary, Alberta, Canada T2S 2G1

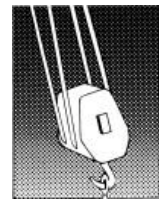

DIAMETER size	TENSILE STRENGTH (LBS)		MAX. WORKING LOAD (LBS)	
	nylon	polyester	nylon	polyester
1/4	2100	2400	210	240
5/16	3400	3600	340	360
3/8	4800	4800	480	480
1/2	8300	9000	830	900
5/8	15200	15300	1520	1530
3/4	19100	19000	1910	1900

NYLON

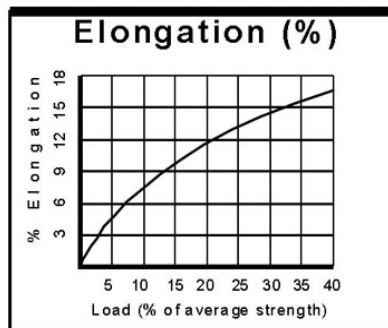

Polyester

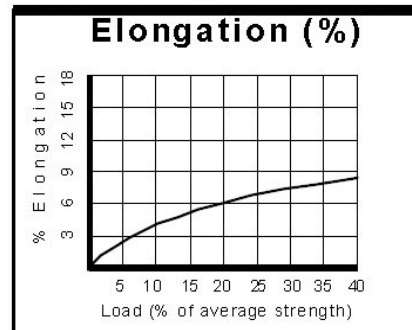

Polyester Stage Ropes

Manufactured by New England Ropes Stage Set X is a superior replacement for manila with a longer life, much higher strength and no slivers. This rope was specially developed as a replacement for manila handlines in counterweight rigging and we find it to be Cadillac of the synthetic handline ropes. Multiline II is a three stranded rope with the same ideals in mind. It is more economically priced and has slightly different handling characteristics.

Stage-Set X

PRODUCT DESCRIPTION: New England Ropes' Stage-Set X is the softest, strongest and most environmentally stable product available in the theatre industry for counterweight systems. It's parallel core of polyester fibre contained within a helically wrapped polyester tape and covered by a braided polyester jacket, remains firm and round under all load conditions and resists crushing in rope locks.



Down Stage Right -Theatrical and Entertainment Rigging Supplies

Office 403.229.0720 Toll Free 1.888.929.0720 Fax 1.866.858.6421

1914 – 5A St SW Calgary, Alberta, Canada T2S 2G1



FEATURES:

- Very low stretch
- Soft and easy to handle
- Remains firm and round in rope locks
- Easy to knot
- Renders well on blocks
- Torque-free non-hockling
- No fiber splinters
- Indefinite shelf life, will not mildew or rot

WORKING ELONGATION

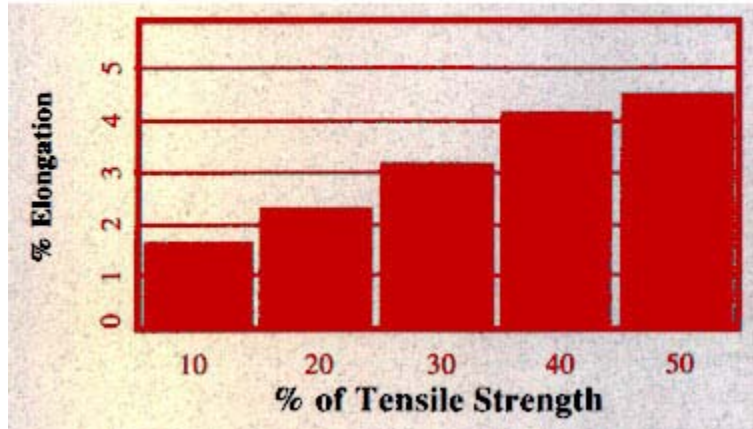

APPLICATIONS:

- Counter weight systems
- General purpose stage rigging

TECHNICAL SPECIFICATIONS:

Product Code (White)	Diameter		Weight (Lbs/100 ft.)	Tensile (Lbs.)
	Inches	mm		
3130-12	3/8"	9	3.8	4,500
3130-14	7/16"	11	5.1	6,300
3130-16	1/2"	12	6.7	7,900
3130-20	5/8"	16	11.2	14,000
3130-24	3/4"	18	14.8	17,600
3130-28	7/8"	22	22.0	26,300
3130-32	1"	24	26.6	31,600

Compliance to the above specifications is based upon testing according to the Cordage Institute Standard Testing Methods for Fiber Rope and/or ASTM D-4268 Standard Methods of Testing Fiber Ropes.

Weights - Are average and may vary +/- 5%

Tensile strengths - Are approximate average for new, unused ropes. To estimate the minimum tensile strength of a new rope, reduce the approximate average by 15% (Cordage Institute defines minimum tensile strength as two standard deviations below the average tensile strength of the rope).

Down Stage Right -Theatrical and Entertainment Rigging Supplies

Office 403.229.0720 Toll Free 1.888.929.0720 Fax 1.866.858.6421

1914 – 5A St SW Calgary, Alberta, Canada T2S 2G1



SUNLIGHT/UV:

Very little degradation from UV. Can be used outside over long term if inspected regularly.

CHEMICALS:

Good resistance to most minerals / organics, acids, weak alkalis, bleaches and other oxidizing agents and most solvents. Polyester is generally considered to have a better overall resistance to acids or oxidizing agents.

HEAT:

Melting point of 480°F, progressive strength loss above 300°F.

DIELECTRICS:

Good resistance to the passage of electrical current. However in rope form, dirt, surface contaminants, water entrapment and the like can significantly affect dielectric properties. Extreme caution should be exercise any time a rope is in the proximity of live circuits.

SHEAVES:

Recommended D/d ratio is 8:1

WORKING LOADS:

No blanket working load recommendation can be made because it depends on the application and conditions of use, especially potential danger to personnel. It is recommended that the user establish working loads and safety factors based on professional and experienced assessments of risks. The working load is a guideline for the use of a rope in good condition for non-critical applications and should be reduced where life, limb, or valuable property is involved, or exceptional service such as shock, sustained loading, severe vibration, etc.

The Cordage Institute specifies that the Safe Working Load of a rope shall be determined by dividing the Minimum Tensile Strength by the Safety Factor. Safety factors range from 5 to 12 for non-critical uses, 15 for life lines.

SLK= Minimum Break Strength / Safety Factor

COATING:

Can be Urethane coated to improve abrasion resistance, UV resistance, to create a water barrier, and to provide color coding.

Down Stage Right -Theatrical and Entertainment Rigging Supplies

Office 403.229.0720 Toll Free 1.888.929.0720 Fax 1.866.858.6421

1914 – 5A St SW Calgary, Alberta, Canada T2S 2G1



SPECIFIC GRAVITY:

COLOR: White, Black, Red, Blue (black "x" tracers)

MULTILINE II

PRODUCT DESCRIPTION:

Multiline II is a 3-strand composite rope, its unique construction combines filament and staple/spun polyester wrapped around a polyolefin core (smaller than 1/2" diameter does not have polyolefin core). Multiline II feels and handles like manila, yet provides greater durability, higher strength, lighter weight, and a consistent supple feel over time.

FEATURES:

- Low elongation
- High Strength
- Abrasion Resistant
- Stays flexible and very easy to handle
- Splices well
- Sure gripping surface
- Renders well around blocks, sheaves, and winches.
- Long service life
- Environmentally stable
- No fiber splinters

APPLICATIONS:

- Hand lines
- Hoisting / Bull Ropes
- Counterweight Rigging
- Drop lines

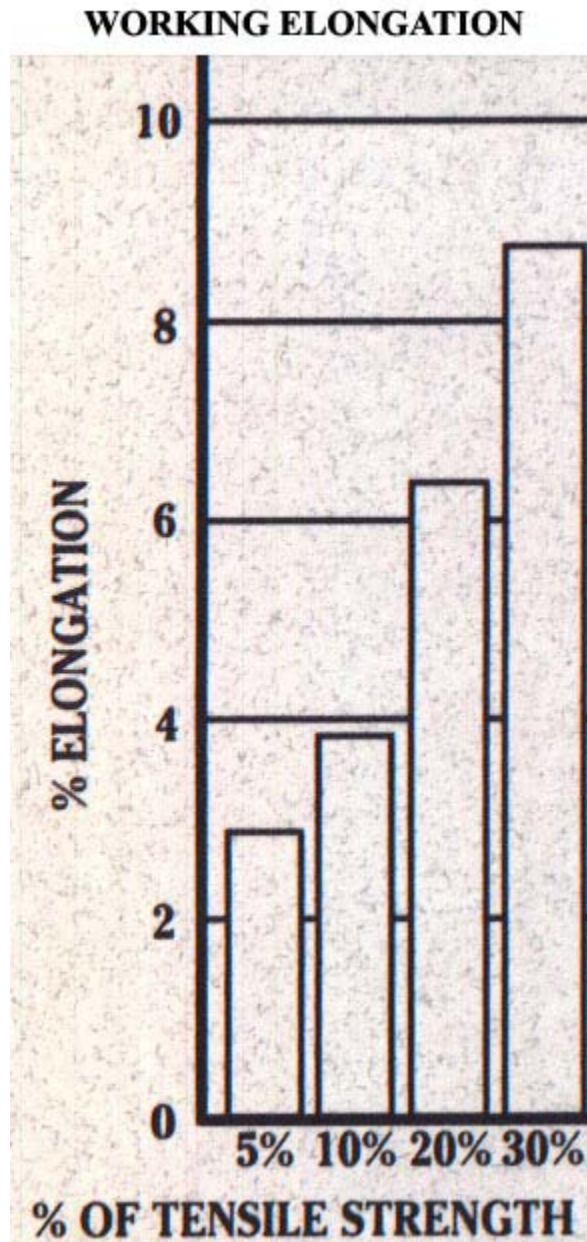

Down Stage Right -Theatrical and Entertainment Rigging Supplies

Office 403.229.0720 Toll Free 1.888.929.0720 Fax 1.866.858.6421

1914 – 5A St SW Calgary, Alberta, Canada T2S 2G1



TECHNICAL SPECIFICATIONS:

Product Code (White)	Diameter		Weight (Lbs/100 ft.)	Tensile (Lbs.)
	Inches	mm		
7300-10	5/16"	8	2.5	2,300
7300-12	3/8"	9	3.6	3,200
7300-14	7/16"	11	5.0	4,100
7300-16	1/2"	12	6.2	5,800
7300-20	5/8"	16	9.5	8,200
7300-24	3/4"	18	13.7	10,500
7300-28	7/8"	22	18.0	15,500
7300-32	1"	24	20.6	18,700

Compliance to the above specifications is based upon testing according to the Cordage Institute Standard Testing Methods for Fiber Rope and/or ASTM D-4268 Standard Methods of Testing Fiber Ropes.

Weights - Are average and may vary +/- 5%

Tensile strengths - Are approximate average for new, unused ropes. To estimate the minimum tensile strength of a new rope, reduce the approximate average by 15% (Cordage Institute defines minimum tensile strength as two standard deviations below the average tensile strength of the rope).

SUNLIGHT/UV:

Polyester jacket protects against UV degradation. The polyolefin fibers are UV stabilized to minimize UV degradation. Can be used outside over long term if inspected regularly.

CHEMICALS:

Good resistance to most minerals / organics, acids, weak alkalis, bleaches and other oxidizing agents and most solvents. Polyester is soluble in 95% sulfuric acid or strong alkalines at boil. Polyolefin is soluble in concentrated chlorosulphonic and sulfuric acids.

DIELECTRICS:

Good resistance to the passage of electrical current. However in rope form, dirt, surface contaminants, water entrapment and the like can significantly affect dielectric properties. Extreme caution should be exercised any time a rope is in the proximity of live circuits.

Down Stage Right -Theatrical and Entertainment Rigging Supplies

Office 403.229.0720 Toll Free 1.888.929.0720 Fax 1.866.858.6421

1914 – 5A St SW Calgary, Alberta, Canada T2S 2G1

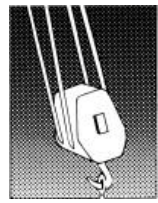

SHEAVES:

Recommended D/d ratio is 8:1

WORKING LOADS:

No blanket working load recommendation can be made because it depends on the application and conditions of use, especially potential danger to personnel. It is recommended that the user establish working loads and safety factors based on professional and experienced assessments of risks. The working load is a guideline for the use of a rope in good condition for non-critical applications and should be reduced where life, limb, or valuable property is involved, or exceptional service such as shock, sustained loading, severe vibration, etc.

The Cordage Institute specifies that the Safe Working Load of a rope shall be determined by dividing the Minimum Tensile Strength by the Safety Factor. Safety factors range from 5 to 12 for non-critical uses, 15 for life lines.

$SLK = \text{Minimum Break Strength} / \text{Safety Factor}$

COATING:

Can be Urethane coated to improve abrasion resistance, UV resistance, to create a water barrier and to provide color coding.

SPECIFIC GRAVITY:

1.20

COLOR:

White (Orange tracer is standard; it is also available without a tracer)

STANDARD LENGTH:

Available in standard 600, 1200, & 2400 ft lengths

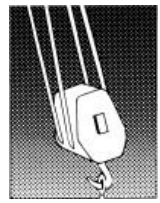

Blocks & Sheaves

Small utility blocks from [Block Division, Inc](#)

These are rated blocks grooved with steel sheaves fitted with Bronze bearings grooved for cable from 1/8” to 3/8” and sheave sizes from 1 1/2” to 5” in diameter. Most blocks are available with single or double sheaves. Sheaves without housings are also available if you want to build your own creations.

Flat Block

Fixed Eye Block

Swivel Eye Block

Deck Block

